



## ASIA'S REVOLUTIONARY STAGE OF ICONIC MICENTERTIANMENT

TRUE ICON HALL is a MICE and entertainment venue, a convergence of design and technology suitable for all arrays of events, the first and only automatic retractable 2,700 seating in Thailand with state-of-the-art light and sound system, advanced technology and professional service.

Located on 7th floor of ICONSIAM, the landmark mega-development of global stature on the Chao Phraya riverside that is a new national destination in Thailand, TRUE ICON HALL offers a one-stop destination for MICE and entertainment events with a totally new experience to all delegates.

### Facility highlights

- Automatic **retractable 2,700 seating** suitable for conference and performance show
- High flexibility with **parallel operable walls** to make each separate hall totally soundproof
- **14 Meeting rooms** for 20-200 seats, some can be combinable up to 520 theatre seats with fully equipped meeting facilities
- **A 1,200 sq.m. foyer (Suralai Hall)** which overlooks the Chao Phraya River
- Offer the **best of its kind when turning to different functions** such as conference, performance, concert, banquet and exhibition
- **Finest equipped** with state-of-the-art light and sound system
- **The most advanced technology** with ultra-high-speed communications

<b>Official Name</b>	TRUE ICON HALL		
<b>Location</b>	7 <sup>th</sup> Floor, ICONSIAM		
<b>Facilities</b>	Gross Area	12,000	sq.m.
	Main Hall (1+2)	2,775	sq.m.
	Hall 1	1,547	sq.m.
	Hall 2	1,183	sq.m.
	Meeting Room	20-200	sq.m.
	Suralai Hall	1,200	sq.m.
<b>Floor Load Capacity</b>	1,000 kg./sq.m		
<b>Hang Load Capacity</b>	500 kg./hanging node		
<b>Ceiling Height</b>	Main Hall	15	m.
	Meeting Room	3.5	m.
	Suralai Hall	8	m.
<b>Loading Facilities</b>	Car lift 3,000 kg. and Truck lift 15,000 kg.		
<b>Stage Rigging</b>	Theatrical standard		
<b>Audio-Visual &amp; Lighting</b>	Basic equipment available		
<b>Telecommunication</b>	Wi-Fi, LAN		

**Catering Service**  
**Accommodations**  
**Access**

**Disabled Access**  
**Car Park**  
**Contact Information**

Professional catering services  
Nearby 5-star and 4-star hotel accommodations  
Citywide transportation: Golden Line Sky Train,  
Boat, Car, Bus, Taxi, Limousine  
Parking, Lift, Toilet  
Over 5,000 indoor car parking spaces  
Email: [sales@trueiconhall.com](mailto:sales@trueiconhall.com)  
[www.trueiconhall.com](http://www.trueiconhall.com)

## CONTACT US



Office +66(0) 2 037 7999



[Sales@trueiconhall.com](mailto:Sales@trueiconhall.com)

<http://www.trueiconhall.com>



299 Soi Charoen Nakhon 5,  
Charoen Nakhon Road, Khlong Ton Sai,  
Khlong San, Bangkok 10600



# DIMENSION AND CAPACITY

Floor	FACILITY	Approximate Floor Area	Approximate Dimensions	Approximate Floor Area	Approximate Dimensions	Suggested Capacity (Persons)				
		(sqm.)	(LxWxH) m.	(sqft.)	(LxWxH) ft.	Theatre	Classroom	U-Shape	Banquet	Standard 3x3 m. Booth
7	MAIN HALL (HALL 1+2)	2,775	(45.5x61.0x15.0)	29,840	(149.2x200x49.2)	2,800	1,400	-	1,000	144
	HALL1	1,547	(45.5x34.0x15.0)	16,636	(149.2x111.5x49.2)	1,296	684	-	480	72
	HALL2	1,183	(45.5x26.0x15.0)	12,727	(149.2x85.3x49.2)	972	570	-	400	60
	SURALAI HALL	1,071	(31.5x34.0x8.0)	11,518	(103.3x111.5x26.2)	1,200	672	-	700	55
7	MEETING ROOM 1-3	364	(11.8x30.9x3.5)	3,920	(38.7x101.3x11.4)	450	255	87	180	
	MEETING ROOM 1	195	(19.5x10.0x3.5)	2,096	(63.9x32.8x11.4)	196	108	54	80	-
	MEETING ROOM 2	200	(19.5x10.3x3.5)	2,153	(63.9x33.7x11.4)	182	96	54	60	-
	MEETING ROOM 3	200	(19.5x10.3x3.5)	2,153	(63.9x33.7x11.4)	168	96	54	60	-
	MEETING ROOM 4-5	141	(7.5x18.9x3.5)	1,525	(24.6x62.0x11.4)	117	72	54	70	
	MEETING ROOM 4	71	(10.7x6.7x3.5)	766	(35.0x21.9x11.4)	60	27	30	40	-
	MEETING ROOM 5	59	(7.9x7.5x3.5)	637	(25.9x24.6x11.4)	42	18	18	30	-
	MEETING ROOM 6-7	52	(4.7x11.2x3.5)	565	(15.4x36.7x11.4)	42	24	27	30	
	MEETING ROOM 6	26	(4.7x5.6x3.5)	282	(15.4x18.3x11.4)	21	12	15	10	-
	MEETING ROOM 7	26	(4.7x5.6x3.5)	282	(15.4x18.3x11.4)	21	12	15	10	-
	MEETING ROOM 8-9	53	(4.7x11.4x3.5)	576	(15.4x37.4x11.4)	42	24	27	30	
	MEETING ROOM 8	26	(4.7x5.6x3.5)	282	(15.4x18.3x11.4)	21	12	15	10	-
	MEETING ROOM 9	27	(4.7x5.8x3.5)	293	(15.4x19.0x11.4)	28	15	15	10	-
	MEETING ROOM 10	136	(15.7x8.7x3.5)	1,468	(51.5x28.5x11.4)	80	36	39	50	
7M	MEETING ROOM 11	50	(6.8x7.4x3.0)	540	(22.3x24.2x9.8)	45	24	20	20	-
8	MEETING ROOM 12	73	(7.7x9.5x3.5)	781	(25.2x31.0x11.4)	48	27	24	40	-
	MEETING ROOM 13	136	(15.3x8.9x3.5)	1,450	(50.0x29.0x11.4)	108	84	42	60	-
	MEETING ROOM 14	122	(15.3x8x3.5)	1,310	(50.0x26.2x11.4)	90	36	42	50	-

REMARKS : 1. The highlights indicate combinable meeting rooms.  
 2. The above approximate figures can be changed without prior notice.  
 3. Number of seating can be changed depending on size of stage.

\*As of January 2020

# 7TH FLOOR

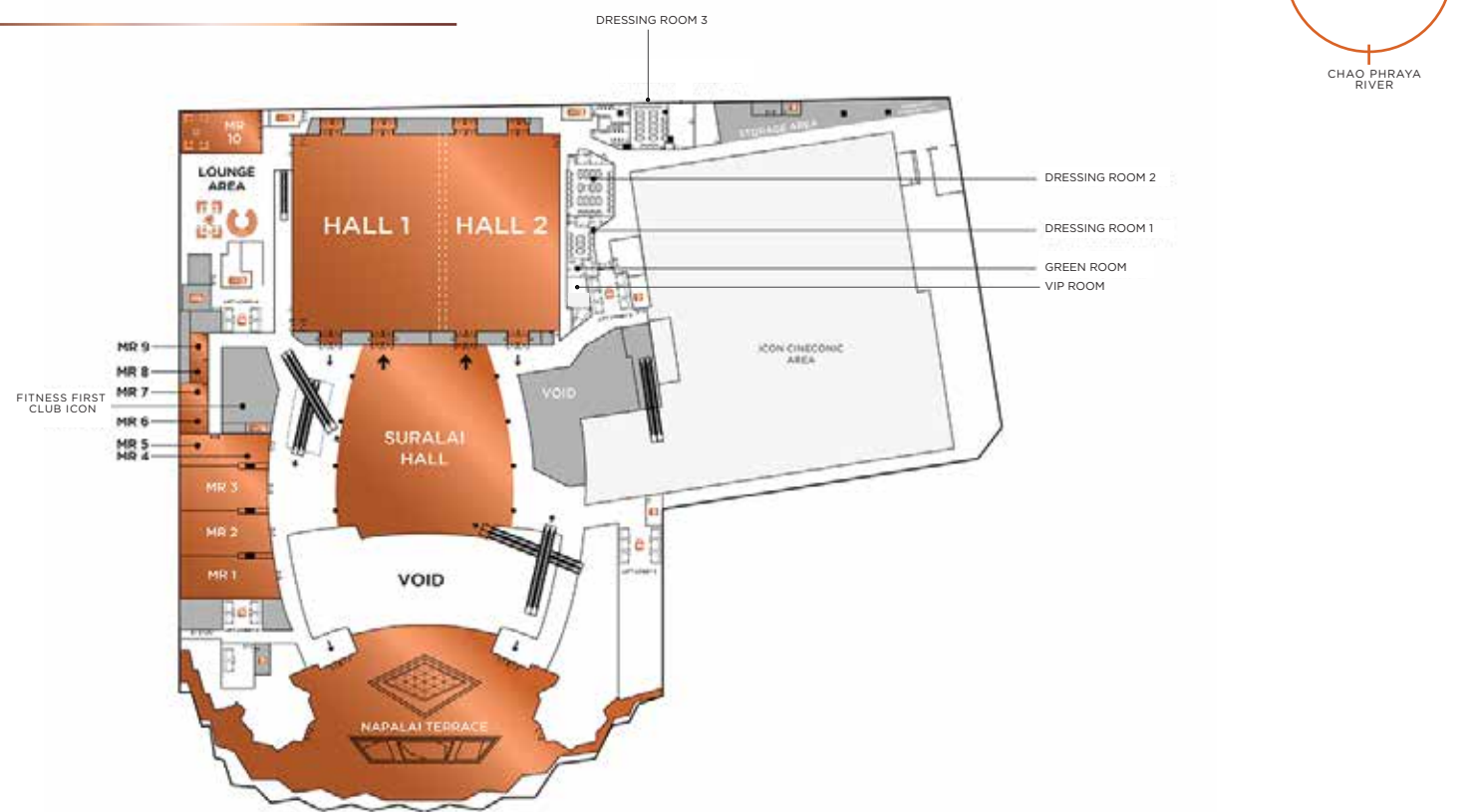

# 7M FLOOR

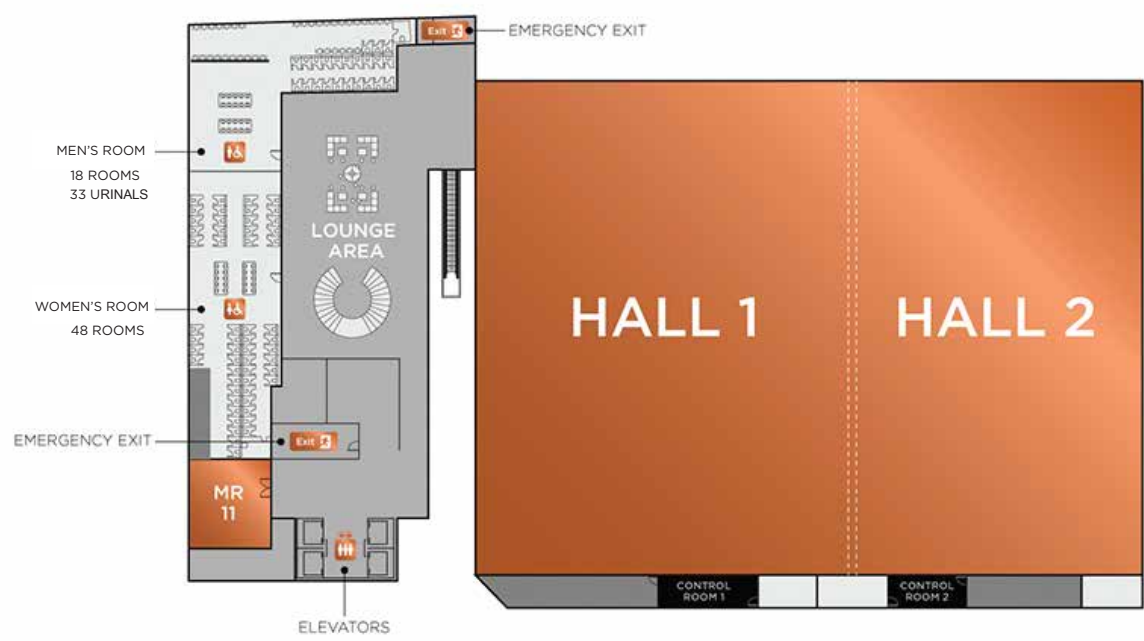



# 8TH FLOOR

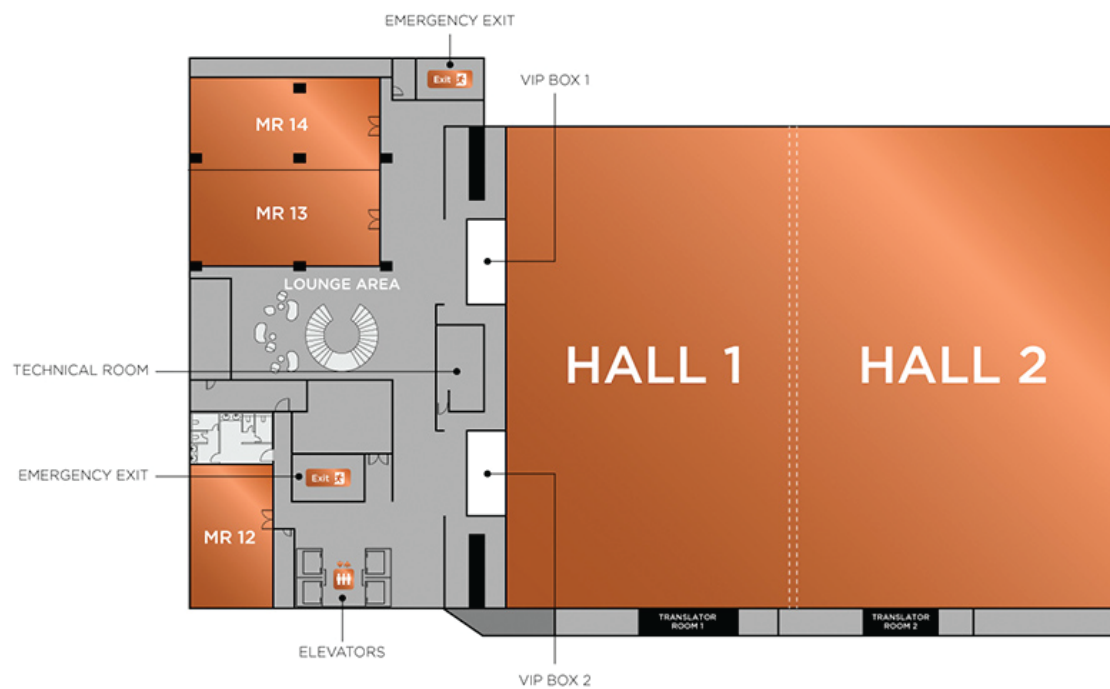

## SOCIAL MEDIA CHANNEL



TRUE ICON HALL



trueiconhall



true\_iconhall



# ICONSIAM

THE ICON OF ETERNAL PROSPERITY



ICONSIAM is a landmark mega-development of global stature on the Chao Phraya riverside that will be a new national destination in Thailand.

## 7 WONDERS AT ICONSIAM

1. River Park – This massive riverside community space is designed for daily use by community members.
2. The Iconic Multimedia Water Features – This multimedia feature, which is the longest in Southeast Asia, is designed to be a global iconic attraction that promotes tourism for Bangkok and Thailand.





3. TRUE ICON HALL – The state-of-the-art and technologically most advanced auditorium in Thailand will have a far-reaching impact on businesses along the Chao Phraya River and will benefit Thailand's MICE industry.
4. River Museum Bangkok – The venue provides cultural space in a commercial project to bring closer to the public's daily life access to world-class art from different countries.



5. SookSiam – This amazing town is Thailand's first co-creation space for local communities from the 77 provinces of Thailand to join together their creative capabilities, business platform and cultural space.
6. Gold Line Monorail - The monorail system will support urban development with road-rail-river transport connections to elevate the public's quality of life.



7. Art Synergy Phenomenon - ICONSIAM houses masterpieces from more than 100 artists in all disciplines ranging from local artists from all regions of Thailand.



Floor	FACILITY	Approximate Floor Area	Approximate Dimensions	Approximate Floor Area	Approximate Dimensions	Suggested Capacity (Persons)				
		(sqm.)	(LxWxH) m.	(sqft.)	(LxWxH) ft.	Theatre	Classroom	U-Shape	Banquet	Standard 3x3 m. Booth
7	MAIN HALL (HALL 1+2)	2,775	(45.5x61.0x15.0)	29,840	(149.2x200x49.2)	2,800	1,400	-	1,000	144
	HALL1	1,547	(45.5x34.0x15.0)	16,636	(149.2x111.5x49.2)	1,296	684	-	480	72
	HALL2	1,183	(45.5X26.0X15.0)	12,727	(149.2x85.3x49.2)	972	570	-	400	60
	SURALAI HALL	1,071	(31.5x34.0x8.0)	11,518	(103.3x111.5x26.2)	1,200	672	-	700	55
7	MEETING ROOM 1-3	364	(11.8x30.9x3.5)	3,920	(38.7x101.3x11.4)	450	255	87	180	
	MEETING ROOM 1	195	(19.5x10.0x3.5)	2,096	(63.9x32.8x11.4)	196	108	54	80	-
	MEETING ROOM 2	200	(19.5x10.3x3.5)	2,153	(63.9x33.7x11.4)	182	96	54	60	-
	MEETING ROOM 3	200	(19.5x10.3x3.5)	2,153	(63.9x33.7x11.4)	168	96	54	60	-
	MEETING ROOM 4-5	141	(7.5x18.9x3.5)	1,525	(24.6x62.0x11.4)	117	72	54	70	
	MEETING ROOM 4	71	(10.7x6.7x3.5)	766	(35.0x21.9x11.4)	60	27	30	40	-
	MEETING ROOM 5	59	(7.9x7.5x3.5)	637	(25.9x24.6x11.4)	42	18	18	30	-
	MEETING ROOM 6-7	52	(4.7x11.2x3.5)	565	(15.4x36.7x11.4)	42	24	27	30	
	MEETING ROOM 6	26	(4.7x5.6x3.5)	282	(15.4x18.3x11.4)	21	12	15	10	-
	MEETING ROOM 7	26	(4.7x5.6x3.5)	282	(15.4x18.3x11.4)	21	12	15	10	-
	MEETING ROOM 8-9	53	(4.7x11.4x3.5)	576	(15.4x37.4x11.4)	42	24	27	30	
	MEETING ROOM 8	26	(4.7x5.6x3.5)	282	(15.4x18.3x11.4)	21	12	15	10	-
	MEETING ROOM 9	27	(4.7x5.8x3.5)	293	(15.4x19.0x11.4)	28	15	15	10	-
	MEETING ROOM 10	136	(15.7x8.7x3.5)	1,468	(51.5x28.5x11.4)	80	36	39	50	
7M	MEETING ROOM 11	50	(6.8x7.4x3.0)	540	(22.3x24.2x9.8)	45	24	20	20	-
8	MEETING ROOM 12	73	(7.7x9.5x3.5)	781	(25.2x31.0x11.4)	48	27	24	40	-
	MEETING ROOM 13	136	(15.3x8.9x3.5)	1,450	(50.0x29.0x11.4)	108	84	42	60	-
	MEETING ROOM 14	122	(15.3x8x3.5)	1,310	(50.0x26.2x11.4)	90	36	42	50	-



Floor	FACILITY	Approximate Floor Area	Approximate Dimensions	Approximate Floor Area	Approximate Dimensions	Suggested Capacity (Persons)				
		(sqm.)	(LxWxH) m.	(sqft.)	(LxWxH) ft.	Theatre	Classroom	U-Shape	Banquet	Standard 3x3 m. Booth
7	MAIN HALL (HALL 1+2)	2,775	(45.5x61.0x15.0)	29,840	(149.2x200x49.2)	2,800	1,400	-	1,000	144
	HALL1	1,547	(45.5x34.0x15.0)	16,636	(149.2x111.5x49.2)	1,296	684	-	480	72
	HALL2	1,183	(45.5X26.0X15.0)	12,727	(149.2x85.3x49.2)	972	570	-	400	60
	SURALAI HALL	1,071	(31.5x34.0x8.0)	11,518	(103.3x111.5x26.2)	1,200	672	-	700	55
7	MEETING ROOM 1-3	364	(11.8x30.9x3.5)	3,920	(38.7x101.3x11.4)	450	255	87	180	
	MEETING ROOM 1	195	(19.5x10.0x3.5)	2,096	(63.9x32.8x11.4)	196	108	54	80	-
	MEETING ROOM 2	200	(19.5x10.3x3.5)	2,153	(63.9x33.7x11.4)	182	96	54	60	-
	MEETING ROOM 3	200	(19.5x10.3x3.5)	2,153	(63.9x33.7x11.4)	168	96	54	60	-
	MEETING ROOM 4-5	141	(7.5x18.9x3.5)	1,525	(24.6x62.0x11.4)	117	72	54	70	
	MEETING ROOM 4	71	(10.7x6.7x3.5)	766	(35.0x21.9x11.4)	60	27	30	40	-
	MEETING ROOM 5	59	(7.9x7.5x3.5)	637	(25.9x24.6x11.4)	42	18	18	30	-
	MEETING ROOM 6-7	52	(4.7x11.2x3.5)	565	(15.4x36.7x11.4)	42	24	27	30	
	MEETING ROOM 6	26	(4.7x5.6x3.5)	282	(15.4x18.3x11.4)	21	12	15	10	-
	MEETING ROOM 7	26	(4.7x5.6x3.5)	282	(15.4x18.3x11.4)	21	12	15	10	-
	MEETING ROOM 8-9	53	(4.7x11.4x3.5)	576	(15.4x37.4x11.4)	42	24	27	30	
	MEETING ROOM 8	26	(4.7x5.6x3.5)	282	(15.4x18.3x11.4)	21	12	15	10	-
	MEETING ROOM 9	27	(4.7x5.8x3.5)	293	(15.4x19.0x11.4)	28	15	15	10	-
	MEETING ROOM 10	136	(15.7x8.7x3.5)	1,468	(51.5x28.5x11.4)	80	36	39	50	
7M	MEETING ROOM 11	50	(6.8x7.4x3.0)	540	(22.3x24.2x9.8)	45	24	20	20	-
8	MEETING ROOM 12	73	(7.7x9.5x3.5)	781	(25.2x31.0x11.4)	48	27	24	40	-
	MEETING ROOM 13	136	(15.3x8.9x3.5)	1,450	(50.0x29.0x11.4)	108	84	42	60	-
	MEETING ROOM 14	122	(15.3x8x3.5)	1,310	(50.0x26.2x11.4)	90	36	42	50	-